

# A284

AUFBAUANLEITUNG - ASSEMBLY INSTRUCTION

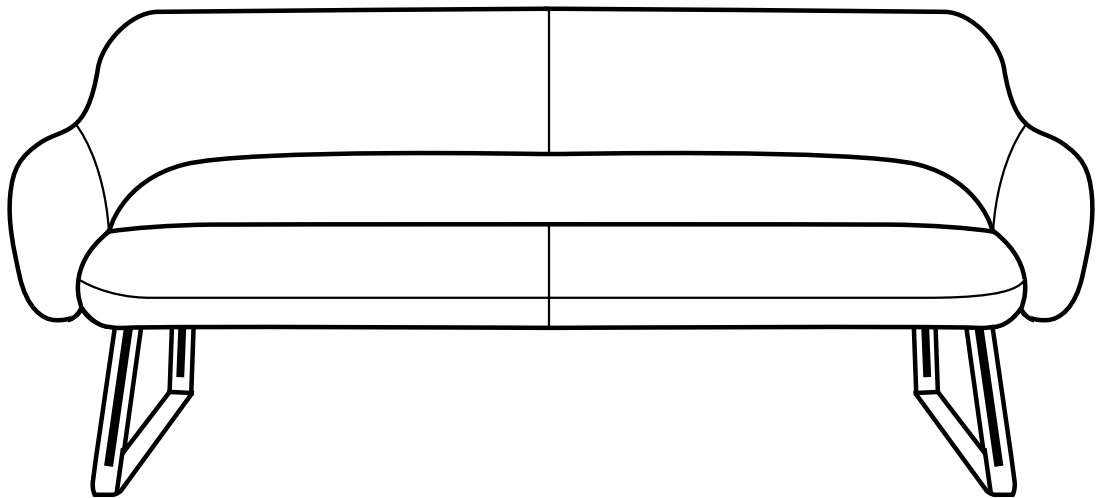

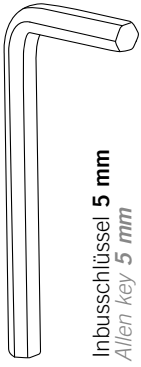

Inbusschlüssel 5 mm  
Allen key 5 mm

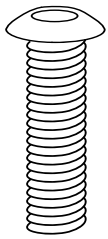

Linienkopfschraube 8x30 mm  
für Kufenmontage Bank und Hocker  
Lens head screw 8x30 mm  
for runner assembly bench and stool

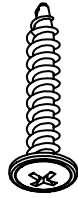

Schraube 5x30 mm für Kufenmontage Hocker  
Screw 5x30 mm for runner assembly stool

**! Hinweis / Note:**

Für den Aufbau werden zwei Monteure benötigt. Somit vermeiden Sie Beschädigungen im Vorfeld.

*Two persons are needed for the assembly. This prevents damage in advance.*

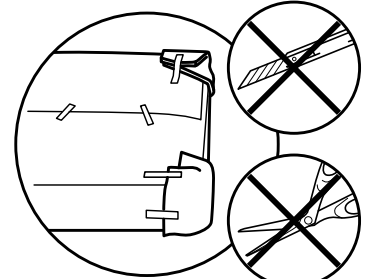
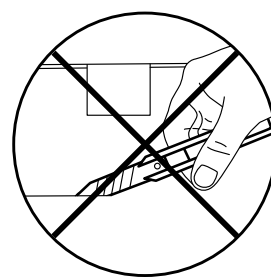
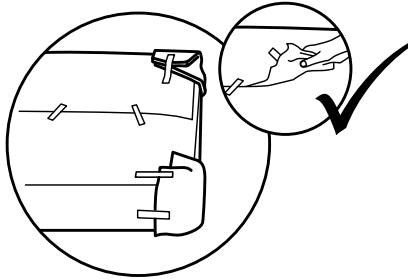
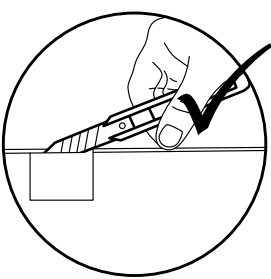
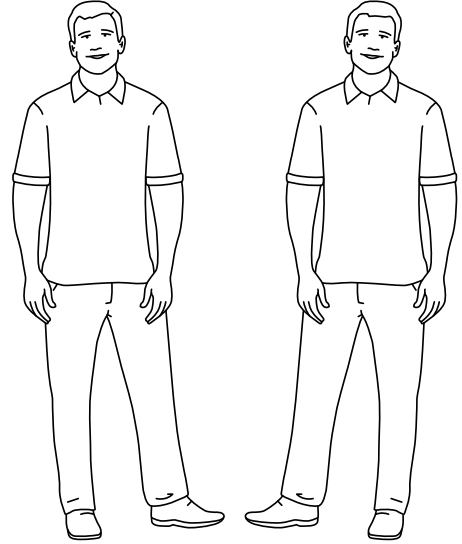

**1 Vorbereiten / Preparation**

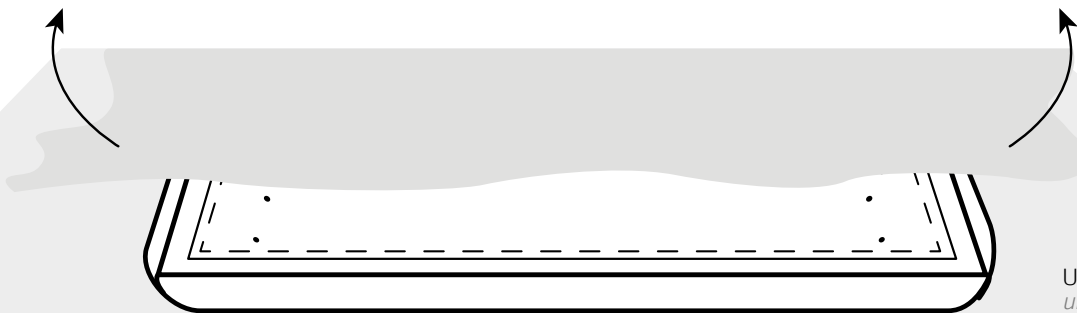

Unterlage / Verpackungsfolie  
underlay / packaging foil

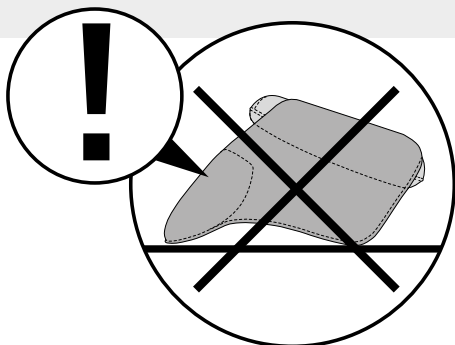

Beliebige Auflage mit Unterlage  
Any support with underlay

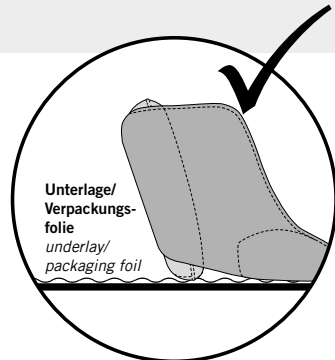

Unterlage/  
Verpackungs-  
folie  
underlay/  
packaging foil

2

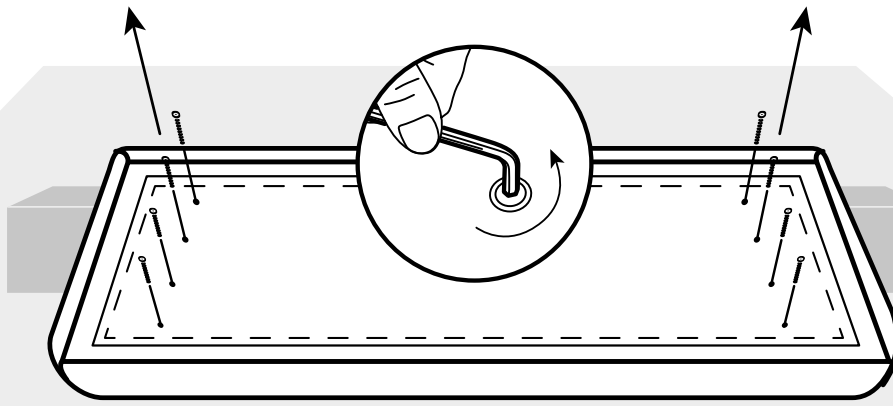

Beliebige Auflage mit Unterlage/  
Verpackungsfolie

Any support with underlay/  
packaging foil

Unterlage / Verpackungsfolie  
underlay / packaging foil

3

Ausführungsabhängig (nur bei Kufen mit Massivholzeinlage)  
design specific (for runners with solid-wooden inlay)

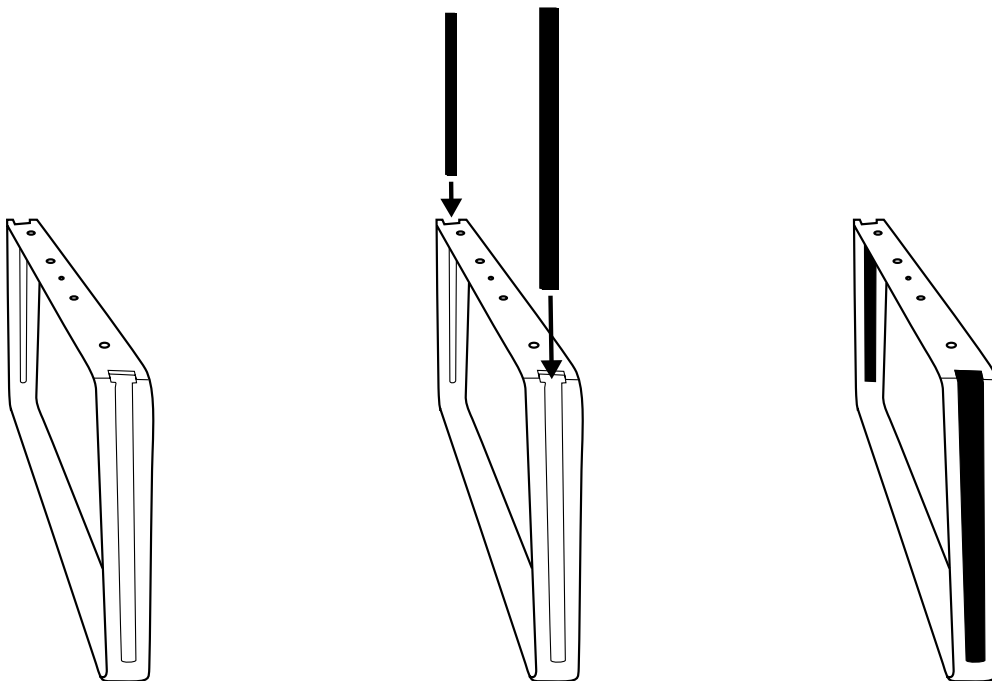

4

Montage Kufen Bank / Assembly runner bench

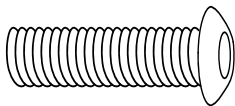

Linsenkopfschraube 8x30 mm  
Lens head screw 8x30 mm

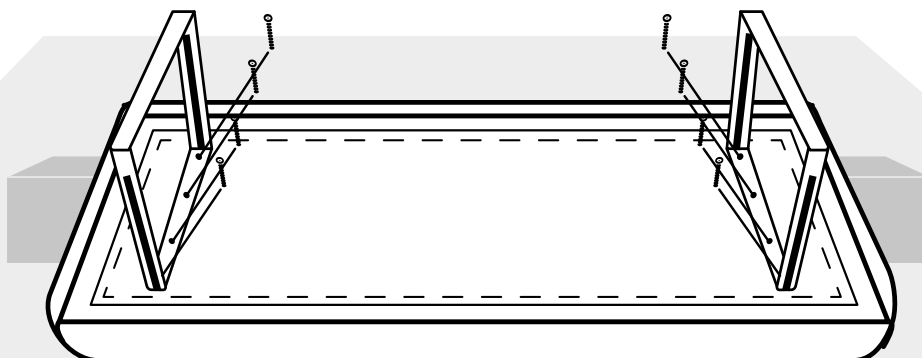
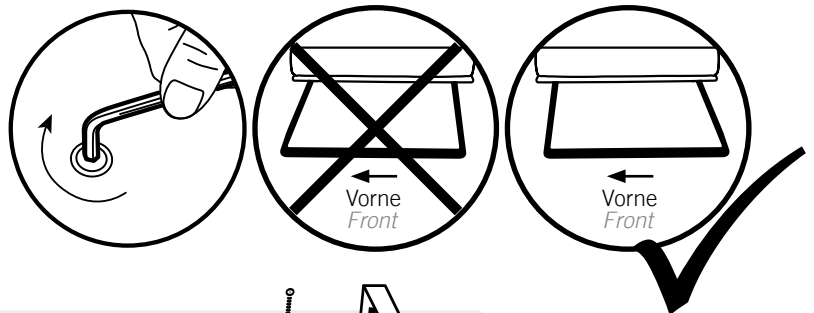

**5** Montage Kufen / *Runner assembly*

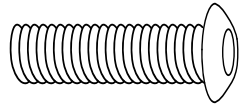

Linsenkopfschraube **8x30 mm**  
*Lens head screw 8x30 mm*

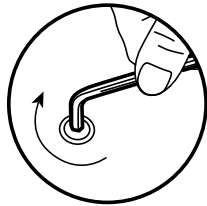

**Bank / Bench**

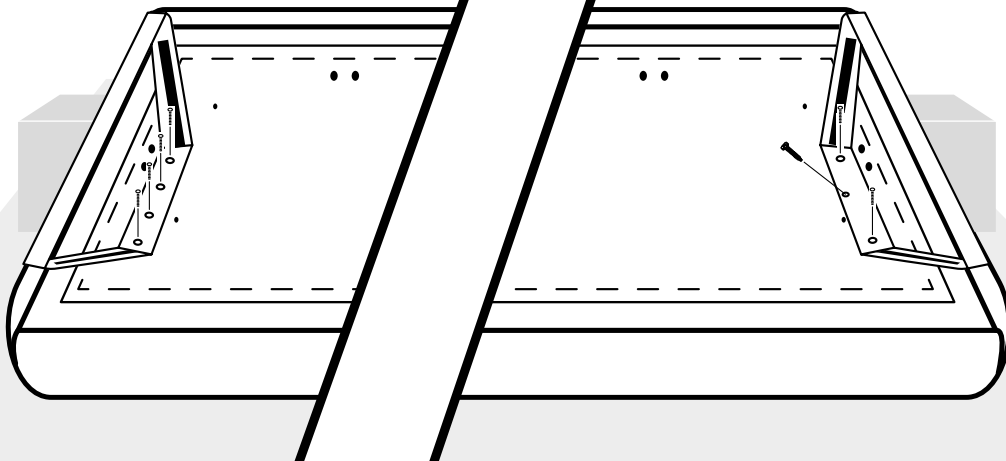

Schraube **5x30 mm**  
*Screw 5x30 mm*

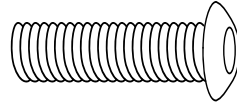

Linsenkopfschraube **8x30 mm**  
*Lens head screw 8x30 mm*

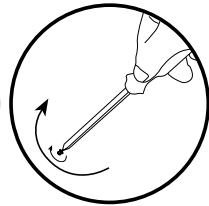
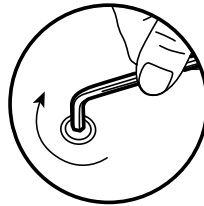

**Hocker / Stool**

**6**

